

PORT MALABAR UNIT TWENTY FIVE

PLAT BOOK 16
Page 81

A RESUBDIVISION OF PORTIONS OF THE FLORIDA INDIAN RIVER
LAND COMPANY, PLAT BOOK 1, PAGE 165, IN SECTIONS 29, 30, 31 AND 32,
TOWNSHIP 29 SOUTH, RANGE 37 EAST
CITY OF PALM BAY, BREVARD COUNTY, FLORIDA
SHEET 14 OF 16 SHEETS

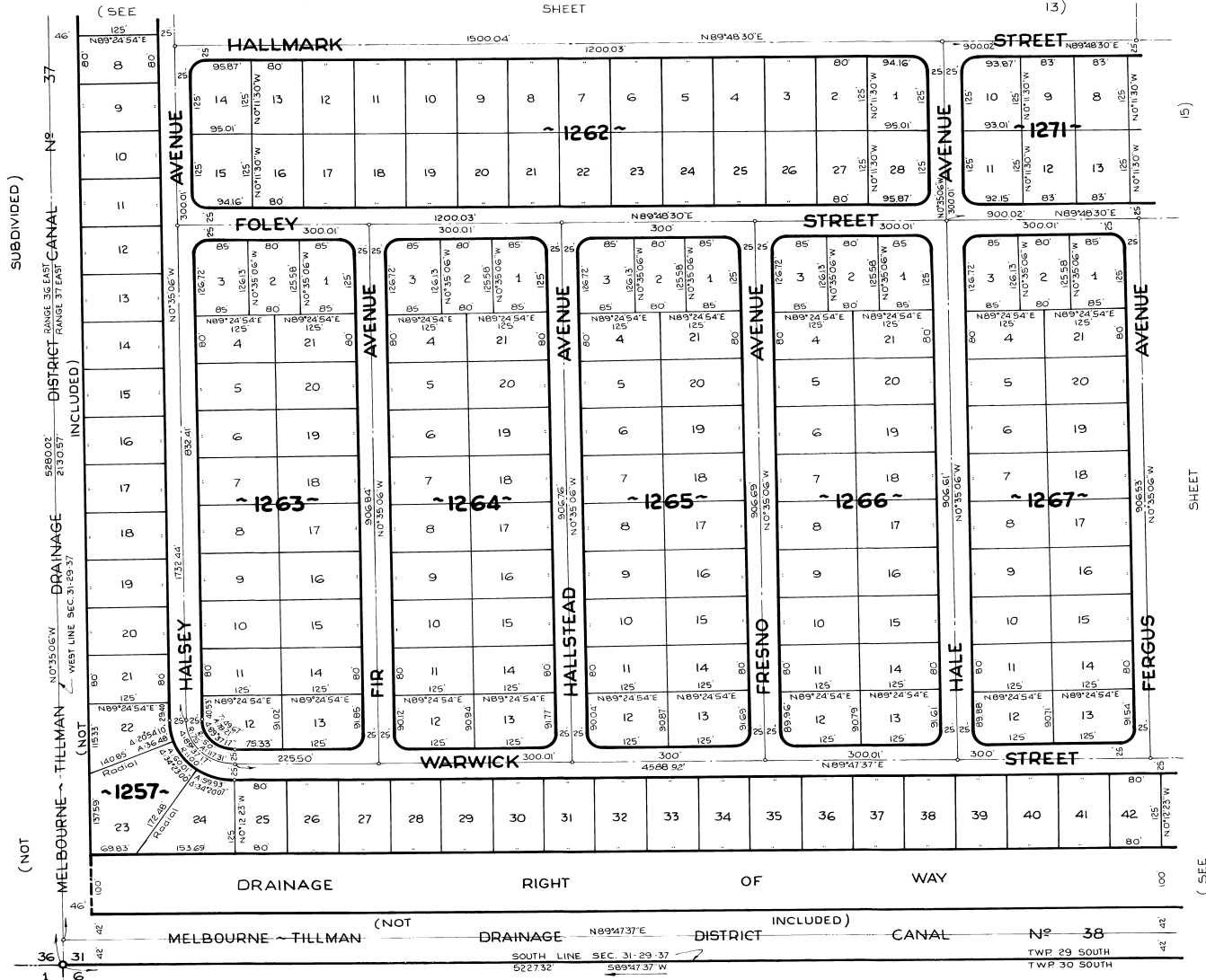

CALCULATED BY: JEC
DRAWN BY: VAK
CHECKED BY: JB
APPROVED BY: CBK

ARTHUR L. DAY
CIVIL ENGINEER
MIAMI - FLORIDA

SHEET 14 OF 16 SHEETS
174 LOTS THIS SHEET